

**TECHNICAL INFORMATION:**

**PAT-7000-001, 7.0 INCH 35 PPF.**



CASING O.D. (in)	7.000
CASING WT. (lb/ft)	35
CASING I.D. (in)	6.004
PATCH MAX. RUNNING O.D. (in)	5.850
PATCH I.D. AFTER SETTING (in)	5.250
PATCH DRIFT I.D. (in)	5.125
BURST HYDRAULIC RATING (psi)	4070
COLLAPSE HYDRAULIC RATING (psi)	3470

QTY.	DESCRIPTION	PART NUMBER	MATERIAL
1	X-SPAN SYSTEM	PAT-7000-001	NOTED
1	PIN ELEMENT	PAT-7000-020	1026
1	BOX ELEMENT	PAT-7000-021	1026
1	TOP SWAGE	PAT-7000-024	4130 / 4140 / 4142
1	BOTTOM SWAGE	PAT-7000-025	4130 / 4140 / 4142
1	O-RING	OOO-V569-160	VITON
1	O-RING	OOO-V569-161	VITON
1	72K SHEAR STUD	PAT-4500-038	4140 / 4142
1	10 FT. SECTION	PAT-7000-027	1026 CDS OR DOM
-	5 FT. SECTION	PAT-7000-028	1026 CDS OR DOM

MINIMUM EQUIPMENT REQUIRED FOR A FULL SYSTEM CONSISTS OF ONE SHORT ASSEMBLY AND ONE SECTION.

**PRODUCT OFFERINGS:**

The Owen X-SPAN® System is an economical, proven, durable and dependable sealing system for the isolation of perforations, splits, corrosion or leaks in all types of tubulars and conditions. This system can utilize a multitude of deployment methods in all types of well bores. The large bore assures easy passage of service tools including bridge plugs, drop balls, seal bore assemblies, logging tools and perforating systems. The minimal surface equipment required for deploying the patch and rig less intervention results in significant savings for the operator.

**BENEFITS/CAPABILITIES:**

The X-SPAN® System Offers:

- A proven, durable and dependable seal
- Deployment on electric wireline, tubing, drill pipe or coil tubing in vertical, deviated or horizontal or geothermal well bores
- An economical and reliable solution for a broad range of applications
- A large bore for easy passage of service tools
- Minimal surface equipment required for deployment

**TECHNICAL INFORMATION:**

**PAT-7000-001, 7.0 INCH 35 PPF.**

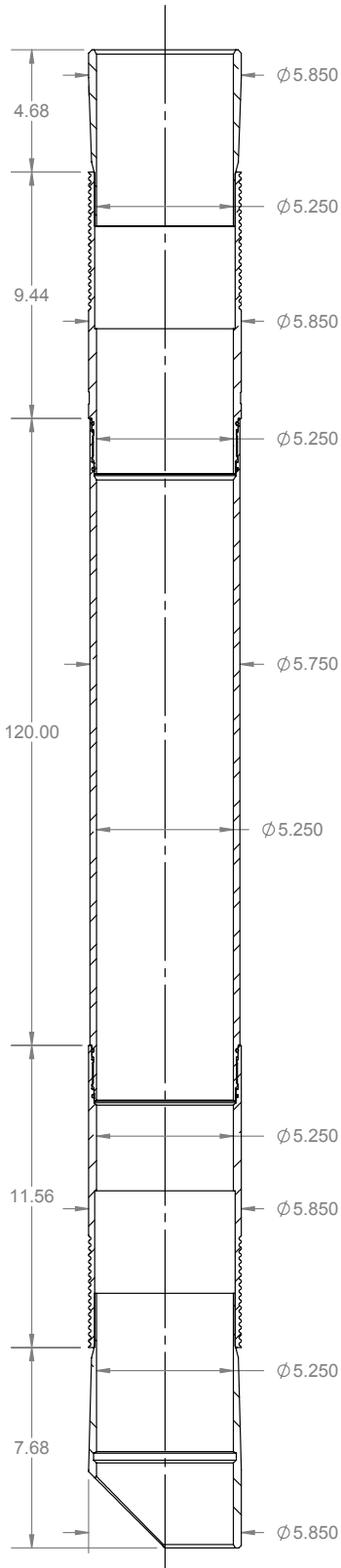

CASING O.D. (in)	7.000
CASING WT. (lb/ft)	35
CASING I.D. (in)	6.004
PATCH MAX. RUNNING O.D. (in)	5.850
PATCH I.D. AFTER SETTING (in)	5.250
PATCH DRIFT I.D. (in)	5.125
BURST HYDRAULIC RATING (psi)	4070
COLLAPSE HYDRAULIC RATING (psi)	3470

QTY.	DESCRIPTION	PART NUMBER	MATERIAL
1	PIN ELEMENT	PAT-7000-020	1026
1	BOX ELEMENT	PAT-7000-021	1026
1	TOP SWAGE	PAT-7000-024	4130 / 4140 / 4142
1	BOTTOM SWAGE	PAT-7000-025	4130 / 4140 / 4142
N+1	O-RING	OOO-V569-160	VITON
N+1	O-RING	OOO-V569-161	VITON
1	72K SHEAR STUD	PAT-4500-038	4140 / 4142
1	SET SCREW 1/4 INCH X 20 TPI, 5/16 INCH	PUR-0501-030	ALLOY
N	10 FT. SECTION	PAT-7000-027	1026 CDS OR DOM
1	SLEEVE NUT	SET-3250-120	4130 / 4140
1	SLEEVE LOCK NUT	SET-3250-121	4130 / 4140
1	SETTING SLEEVE ASSEMBLY	SET-3250-178	NOTED
1	QUICK CHANGE ROD	SET-3250-130	4130 / 4140
1	QUICK CHANGE NUT	SET-3250-131	4130 / 4140
1	LOCK NUT	SET-3500-025	1213 - 1215
1	TOP ADAPTER ROD	SET-3250-132	4130 / 4140
N+1	ROD TANDEM CONNECTOR	SET-3250-133	4130 / 4140
N	10 FT. ROD	SET-3250-134	4130 / 4140
OPT	BOTTOM ROD	SET-3250-136	4130 / 4140
1	COLLET ASSEMBLY	SET-3250-180	NOTED
1	END SUB	SET-3250-176	4130 / 4140 / 4142
1	COLLET SUPPORT	SET-3250-177	4130 / 4140
N	ROD SUPPORT	SET-3250-195	ALUMINUM
1	COLLET SUPPORT	SET-3250-177	4130 / 4140
N	ROD SUPPORT	SET-3250-195	ALUMINUM

MINIMUM EQUIPMENT REQUIRED FOR A FULL SYSTEM CONSISTS OF ONE SHORT ASSEMBLY AND ONE SECTION.

**EXTENSION SPECIFICATIONS:**

**PAT-7000-001, 7.0 INCH 35 PPF.**

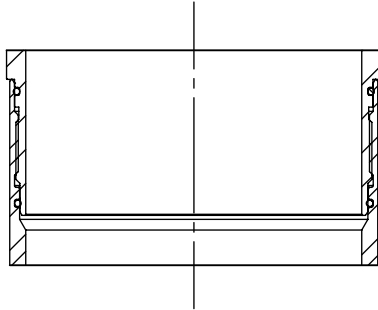

PART NUMBER	LENGTH (INCHES)	OAL (INCHES)	WEIGHT (LBS.)	MATERIAL
PAT-7000-027	120	122.13	147.3	1018 / 1026
PAT-7000-028	60	62.13	73.6	1018 / 1026

PATCH TENSILE RATING	75,000 LBF
----------------------	------------

**SYSTEM WEIGHTS:**

	WEIGHT (LBS.)
PAT-7000-001	42.2
10 FT PATCH RUNNING WEIGHT	330.2
EA. ADDITIONAL 10 FT. LGTH ADD	209.3

**SETTING TOOL OPTIONS:**

HYDRAULIC			WEIGHT (LBS)
4-1/2 INCH HYDRAULIC	SET-4500-010		880
3-1/8 INCH HYDRAULIC	SET-3125-010		300
3-1/4 INCH MULTISTAGE SETTING TOOL INTERNALLY STROKED (HYDRAULIC)	SET-3250-410		287
	SCREEN SUB	TT0798-288A	
	CIRCULATION SUB	SET-2875-010	
	DUMP SUB	OT0710-288B-000	

PYROTECHNIC			WEIGHT (LBS)
3-1/4 INCH MULTISTAGE SETTING TOOL	SET-3250-000		206
3-1/4 INCH MULTISTAGE SETTING TOOL INTERNALLY STROKED	SET-3250-400		200
	POWER CHARGE	OPC-3250-000-MS	
	IGNITER	DET-5306-074	
		DET-5306-008	
4-1/2 INCH MULTISTAGE SETTING TOOL	SET-4500-000		700
	POWER CHARGE	JEC-0450-140	
	IGNITER	DET-5306-074	
		DET-5306-008	