

TECHNICAL INFORMATION:

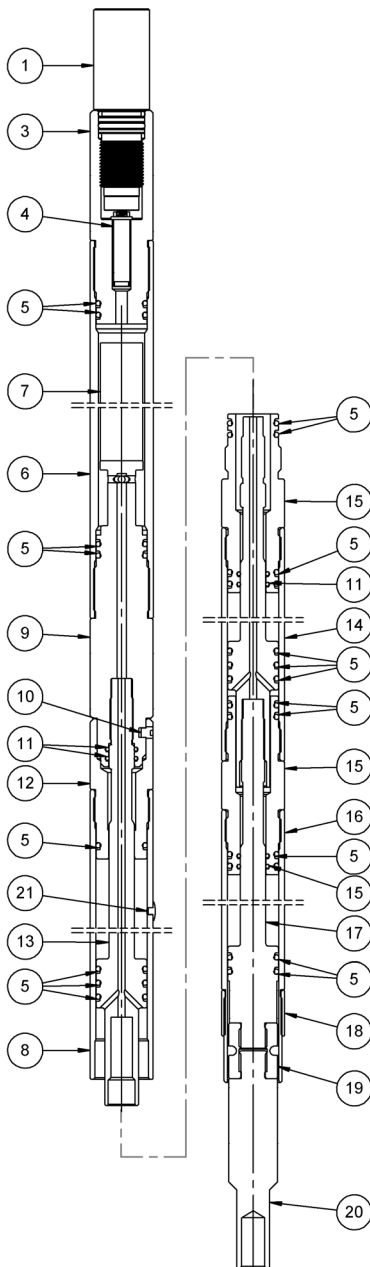

BILL OF MATERIAL:

ITEM	QTY.	PART NUMBER	DESCRIPTION
1	1	AES-AS80005	1-1/2" HP FIRING HEAD
2		SET-1687-100	ASSY. - 1-11/16" O.D. MULTI-STAGE SETTING TOOL ITEMS 1, 4 & 7 NOT INCL. IN ASSY.
3	1	SET-1687-010	FIRING HEAD
4	1	DET-5306-074 DET-5306-075	IGNITER
5	21	OOO-V569-216	O-RING
6	1	SET-1687-102	POWDER CHAMBER
7	1	OPC-1687-000-MS* JEC-5332-024	POWERCHARGE
8	1	SET-1687-106P	WORKING CYLINDER WITH PORT
9	1	SET-1687-013 SET-1687-013C*	SHEAR SUB SYPHON SHEAR SUB
10	1	SET-2125-020	SHEAR PIN
11	6	OOO-V569-115	O-RING
12	1	SET-1687-004	SHEAR SLEEVE
13	2	SET-1687-105	TOP PISTON
14	1	SET-1687-106	WORKING CYLINDER
15	2	SET-1687-111	TANDEM SUB
16	1	SET-1687-107	BOTTOM CYLINDER
17	1	SET-1687-108	BOTTOM PISTON
18	1	SET-1687-009	LOCK RING
19	1	SET-1687-112	SAFTEY RELEASE NUT 25K
20	1	SET-1687-113	BOTTOM ADAPTER
21	1	SET-3500-030	PLUG NYLON
		SET-1687-116	REDRESS KIT - ALL TEMP (ITEMS 5,10,11 & 21)
		MAN-SET-010	MANUAL

***Use SET-1687-013C when using OPC-1687-000-MS**